

INTO»MANCHESTER
IN PARTNERSHIP WITH MANCHESTER METROPOLITAN UNIVERSITY



AN AMBITIOUS UNIVERSITY IN A TOP GLOBAL STUDENT CITY

University pathways for international students

2023-24



BOLD, AMBITIOUS, MODERN.

Welcome to INTO Manchester, your pathway to a degree from Manchester Metropolitan University – a bold, ambitious and modern university.

Following the successful completion of your INTO pathway, we give international students like you the opportunity to study at this diverse and inclusive university in the heart of Manchester.

When you choose INTO Manchester in partnership with Manchester Metropolitan University, we'll help you to push the boundaries of what is possible.

During your pathway programme you can expect a **tailored learning experience** that helps you feel like a Manchester Met student from day one. Visit University faculties, learn about degrees from lecturers and take advantage of the many facilities available to you as an INTO student.

We'll also help you **improve your English language skills**, adjust to life in the UK and make sure you're prepared for the academic expectations at Manchester Metropolitan University.



"We can't wait to welcome you to the dynamic city of Manchester and help you settle into life in the UK. We have a team of experienced staff to help you with both academic matters and day-to-day living, so you can concentrate on your studies and make the most of your time with us."

DAWN ABBOTT
Centre Director, INTO Manchester

*Compiled from HESA 2020/21 data, including students on distance learning courses and accredited courses at partner institutions



Benefit from global industry links

Partnerships and links to international companies like Nike, IBM, Bentley Motors, Volkswagen, Walt Disney and many more



Choose a career-boosting, industry-focused degree

Gain a degree accredited by one of more than 70 professional bodies including: ACCA, AMBA, CMI, EQUIS, RIBA



Join the UK's greenest university

Do your part at the UK's most sustainable university

(People & Planet University League 2021)

THE MOST AFFORDABLE ELITE UK BUSINESS SCHOOL

Study at a global **top 1% business school**¹ for a great value price. Manchester Met is the most **affordable triple-accredited business school in the UK** for undergraduate students². Accept your place to secure the same tuition fees for the duration of your degree³.

¹ MBA Today List of Triple-Accredited Business Schools 2021

² Compared with the average tuition fees from UK business schools that are triple accredited, as taken from the Reddin Survey 2021

³ Subject to completing your degree within the agreed timeframe.

ACHIEVE THE CAREER OF YOUR DREAMS

Manchester Met is dedicated to turning your career ambitions into reality. Thanks to the University's impressive network of industry partners, there are many courses that offer internships and work placements. You can also make use of the extensive Careers Service. Even after you graduate, you'll receive digital careers support for life!



"My internship at Oldham Council during my degree prepared me for the real world of work and gave me the experience I needed in the payroll field to progress even further. My time spent studying at INTO Manchester and then Manchester Met was amazing. I would highly recommend this route to students who want to gain professional experience and get ahead before graduation."

Jyotiben, Kenya

Senior Payroll and Pension Advisor at Lord's (Marylebone Cricket Club) in London

- International Foundation
- BSc (Hons) Business Management



"As long as you apply yourself and you are interested, you can get to whatever you want to do from INTO and from Manchester Met."

Brien, Singapore

Physiotherapist at Bolton Royal Hospital

- International Foundation
- BSc (Hons) Physiotherapy



"Having the opportunity to do an internship year at the Walt Disney Company during my degree definitely gave me a competitive edge. It means I graduated with one year's work experience, which I believe is key in today's market."

Jatin, Kuwait

Quantitative Risk Management at USAA

- International Foundation
- BA (Hons) Accounting and Finance



BRING OUT THE BEST VERSION OF YOU

Manchester Met's Careers Service will help you to plan now, for careers success later. Services include:

- sandwich year options and short-term placement opportunities for many courses
- volunteering and internship opportunities
- 'Innospace', Centre for Enterprise and the Student Enterprise Society to support your start-up
- help with part time student roles
- face-to-face and digital careers and employer events
- iDEA, the Inspiring Digital Enterprise Award that helps you to develop digital, enterprise and employability skills for free

Manchester Met graduates have gone on to work for:

- AMAZON
- ASTRAZENECA
- BARCLAYS
- BBC
- FACEBOOK
- IBM
- LLOYDS BANKING GROUP
- MICROSOFT
- NHS
- PWC
- QATAR AIRWAYS

INTO MANCHESTER: BE PART OF THE BUZZ

Welcome to INTO Manchester, your international study centre. The INTO Centre is the heart of student life, a place where you'll get all the support you need from our friendly and experienced staff. You'll find all your essentials here – from quiet study spaces to bustling social areas.

A STUDENT COMMUNITY IN THE CITY

You'll study your pathway programme at INTO Manchester, in the city centre. So, you won't be far from all the world-class student facilities at Manchester Met.

You'll have access to everything from libraries and facilities to sports centres and cafés popular with university students.

94%

student satisfaction for support

(INTO Annual Student Experience Survey 2022)

EXPERT STUDENT SUPPORT

From the moment you arrive in Manchester to the day you progress to your degree, you'll benefit from a wide range of tailored support. We'll help you with:

- opening a bank account and registering with a doctor
- visa and immigration support services
- 24/7 security and an out-of-hours emergency helpline
- a fun-filled orientation programme in your first week
- additional support for students under 18



DID YOU KNOW?

The worker bee is the symbol of the city of Manchester – and has been for 150+ years! It represents the hard work ethic of the people of Manchester and that the city is a hive of activity.

YOUR STUDENT ACCOMMODATION

Live and learn as part of a vibrant student community at INTO Manchester in partnership with Manchester Metropolitan University. Choose from a range of accommodation options designed to suit you, with expert support from our on-site team.

ENSUITE STUDENT RESIDENCES

Just a short walk from the INTO Centre, your accommodation has a central location which means you'll be close to many restaurants, cafés and shops.

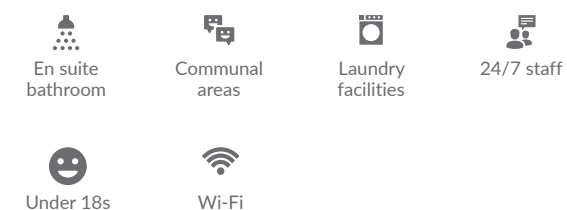
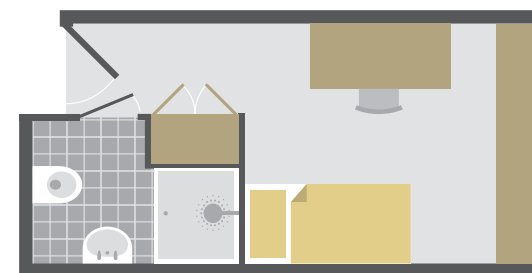

INTO CENTRE FACILITIES

- Modern classrooms with digital whiteboards.
- Well-equipped computing suites.
- A Learning Resource Centre with a wide range of physical and digital materials.
- 24/7 access to our virtual learning environment to download resources.
- Silent study areas.
- University-style science labs.
- Support team and 24/7 assistance.

SUPPORTING YOU

In all the residences, you'll find staff available 24/7 to offer support, and we'll also provide you with a 24-hour emergency helpline telephone number. If you're under 18 and living in INTO managed accommodation, we offer extra support from residential tutors; as well as checking in on you each day at the student residence where you live.



"Progression to a university in the UK is made so much easier with the Placements team at INTO Manchester. Steven and Rebecca were a great help and they really went the extra mile to assist me with my UCAS application. You can always drop by the team's office or write them an email and they will be more than willing to help you out with anything in the shortest amount of time."

William, Singapore

- International Foundation
- BSc (Hons) Physiotherapy



INTO Manchester students also have access to these Manchester Met facilities:

- On-campus library
- Art and Design studios*
- Sugden Sports Centre
- Campus cafés and restaurants

* For students on the Art and Design pathway only

MANCHESTER MET: EXPLORE, DISCOVER, CREATE.

Find a degree that defines you at Manchester Met. Choose from hundreds of specialist subjects from animation to zoology. The University can offer you a route to some of the top schools in the UK including the School of Art, the School of Architecture, and its triple-accredited Business School.

Which path will you take?



BUSINESS

Choose Manchester Met and you choose the UK's most affordable, elite business school¹. Pick from a diverse range of business-related degrees and make the most of extensive links to local and international companies.

- Manchester Met's Business School is triple-accredited, placing it in the global top 1%².
- 18th in the UK for Hospitality, Event Management and Tourism³.
- More than 1,000 placement vacancies each year for students to choose from.
- The Business School has links with global organisations such as PwC, Walt Disney, Pfizer and the Rugby League World Cup.

Business School features

- One of the largest business faculties in the UK with 10,000 students.
- Dedicated Student Hubs, Jobs Hub and Careers and Employability service.
- The Business School has been constructed to the highest standards of energy efficiency and sustainable development currently achievable.
- State-of-the-art computer labs and technology suites.

ART AND DESIGN

Create and collaborate at the prestigious Manchester School of Art. Learn from experienced, practicing artists who are specialists in their field. You can also take advantage of the school's well-established links to the wider creative industries in Manchester and globally.

- One of the UK's biggest and oldest art schools.
- Top 20 in the UK for Design and Crafts³.
- Offering a broad range of arts degrees including architecture, art, design, fashion, media and theatre across the Faculty of Arts and Humanities.
- School is housed in the RIBA award-winning Benzie Building.

Art and Design features

- The £35m School of Digital Arts (SODA) features film studios, green screens and music studios.
- The Manchester School of Architecture is ranked 7th in the world⁴.
- 15 specialist workshops, from ceramics to weave and 3D printing to photography.
- On-site materials stores and AV equipment to help you bring your projects to life.
- Specialist IT facilities with industry standard software, including video editing and animation suites.

ENGINEERING

Study engineering at Manchester Met and gain the skills and practical project experience that reflects a career in the industry. From mechanical and electrical engineering to product design and software engineering, you can expect a broad and flexible range of courses.

- An academic partner of The Institution of Engineering and Technology (IET).
- Join one of the largest research-led science and technology educators in the UK.
- 7th in the UK for Electronic and Electrical Engineering³.
- Spend a year in industry with placement opportunities.
- Some of our international graduates have gone on to become 3D CAD designers, crash test engineers, electronic engineers, systems integration and test engineers, and product designers.

Engineering features

- The Manchester Fuel Cell Innovation Centre, offering advanced equipment across seven specialist labs.
- PrintCity – a digital manufacturing hub offering eight printing technologies, including 3D printers.
- Opening in 2023, the new Dalton Building for Science and Engineering offers modern laboratories and workshops with world-class equipment such as the 200-capacity Super Lab.

¹ Compared with the average tuition fees from UK business schools that are triple accredited, as taken from the Reddin Survey 2021

² MBA Today List of Triple-Accredited Business Schools 2021

³ Guardian University Guide 2022

⁴ QS World Rankings by Subject 2022



Manchester Met
is currently investing

£400M

in new facilities, buildings
and public spaces

DISCOVER MANCHESTER

A magical mix of music, museums, sports and shopping makes Manchester one of the UK's great student cities. It's also a welcoming and diverse place that's ranked among the top 10 friendliest cities in the world*.

* The World's Friendliest Cities, Rough Guides 2021

MANCHESTER AND GREATER MANCHESTER

Explore Manchester by tram, train or on foot. Whichever way you choose to get around, there's plenty to discover:

OLD TRAFFORD AND SALFORD

Home to Manchester United, The Trafford Centre for big brand shopping and nearby MediaCityUK – headquarters of the BBC.

DEANS GATE

Manchester's entertainment hub. Great Northern Warehouse offers shopping, 24-hour gaming, a cinema and international restaurants.

NORTHERN QUARTER

Watch the world go by in Manchester's trendiest neighbourhood. Known for vintage fashion, record shops and cool coffee houses.

SPINNINGFIELDS

This city centre destination is for food lovers, from fine dining at The Ivy to East-Asian inspired Itsu and much more.

NORTH-WEST ENGLAND

Go beyond Manchester.

Head further from the city and experience some of the UK's most iconic natural scenery, including:

LAKE DISTRICT

England's largest national park and a UNESCO World Heritage Site. Visit quaint English villages and walk or cycle along the iconic Lake Windermere.

PEAK DISTRICT

A popular national park that's home to historic market towns and medieval castles. The picturesque valleys of the Peak District see more than 1 million visitors a year.

CHESTER AND NORTH WALES

Chester is one of England's best preserved medieval cities. Nearby North Wales is home to dramatic coastlines and charming countryside unlike anywhere in the world.

17,000+

international students
(HESA 2021/22)



GETTING AWAY

LONDON
2 hours by train

LIVERPOOL
40 minutes by train

EDINBURGH
3 hours by train

YORK
1 hour 20 minutes
by train

AMSTERDAM
1 hour 15 minutes
by plane

PARIS
1 hour 30 minutes
by plane

=3rd

Best UK student city
(OS Best Student Cities 2023)

CAREERS MADE IN MANCHESTER

Manchester is the birthplace of the industrial revolution. And today, it's one of the UK's fastest growing cities**. It's also the leading tech city in the UK outside of London†, with more than 50,000 employed in the sector. Other popular industries include retail, marketing, media and finance. Whatever you choose to study, Manchester will match your career ambitions.

Global companies with a headquarters in Manchester:

- ADIDAS
- AJ BELL
- ASTRAZENECA
- BARCLAYS
- BBC
- DELOITTE
- GOOGLE
- KPMG
- SIEMENS
- SKY

Manchester is home to:

- Premier League football clubs, Manchester City and Manchester United
- Old Trafford Cricket Ground, an international test cricket venue and home to Lancashire County Cricket Club
- an Olympic-size swimming pool at the purpose-built Manchester Aquatics Centre

Which team will you support?

** Centre for Cities: City Space Race 2018

† CBRE Tech Cities Report 2022

Choosing your course

Prepare for your university degree with our academic courses, available in a range of subject pathways. Designed in partnership with Manchester Metropolitan University, this is what your study journey could look like.

Academic courses

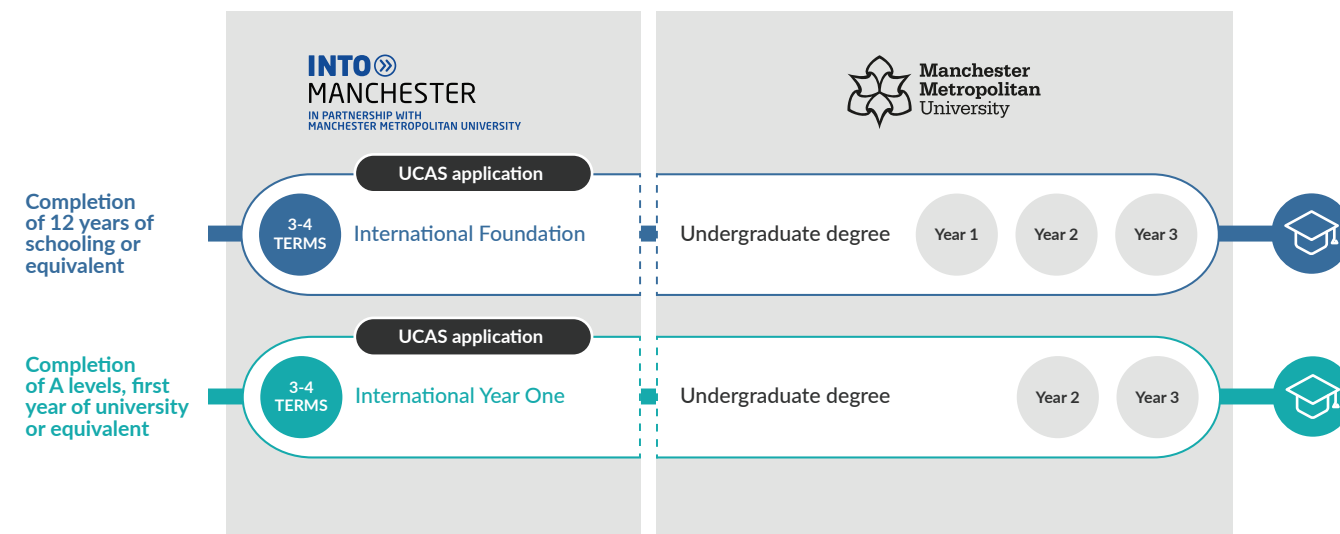

Progressing to Manchester Metropolitan University

Our dedicated Student Placement team, along with the University's International Progression Manager, will provide you with practical advice on progressing to Manchester Met. Along with submitting a UCAS application, you must successfully complete your INTO Manchester course and meet any conditions for progression to your chosen degree.

English language courses

Improve your English level fast with tailored, personalised support.

Academic English

- An immersive course with small class sizes that will give you rapid progress of 0.5 to 1.0 IELTS point per term.
- More than language learning – develop the academic skills needed for successful UK study.
- Take as a standalone course or combine with an academic study plan for a seamless transition to further studies.
- Online and on-campus courses with flexible start dates from January to September. Study lengths from 1 to 4 terms.

For more information, visit:
www.intostudy.com/into-manchester/ae

Do I need to take a preparation programme?

If you already meet the University's academic and English language requirements for your chosen degree programme, you may be eligible to apply directly to an undergraduate or postgraduate degree. For more information, visit: www.intostudy.com/mmu/courses/direct-entry-degree

International Foundation

16 years and above

3-term: Sep or Jan
4-term: Jun or Sep

3-term: IELTS 5.0 (with a minimum of 5.0 in writing) or equivalent.
4-term: IELTS 4.5 (with a minimum of 4.5 in writing) or equivalent.

3-term: Sep or Jan
4-term: Jun or Sep

3-term: IELTS 5.0 (with a minimum of 5.0 in writing) or equivalent.
4-term: IELTS 4.5 (with a minimum of 4.5 in writing) or equivalent.

3-term: Sep or Jan
4-term: Jun or Sep

3-term: IELTS 5.0 (with a minimum of 5.0 in writing) or equivalent.
4-term: IELTS 4.5 (with a minimum of 4.5 in writing) or equivalent.

Age requirement
Start dates
English requirements

Improve your subject knowledge and English language skills to the level you need to begin Year 1 of an undergraduate degree at Manchester Metropolitan University.

Art and Design – FAD

Choose from 15+ degrees.



Enjoy hands-on, practical-based learning at the art and design studios at Manchester Metropolitan University. Progress to a degree at Manchester School of Art, one of the UK's oldest art schools.

What will I study?

- English for Academic Study (30 credits)
- Studio 1: Exploring Visual Language (30 credits)
- Studio 2: Developing Specialist Pathways (30 credits)
- Studio 3: Final Major Project (30 credits)

You'll need to earn 120 credits from all modules

Guidance for portfolio submission: Applicants will need to submit a small portfolio. For more information, visit: www.intostudy.com/en/mmu/artdesign

Business and Humanities – FBH

Choose from 150+ degrees.



Choose from a huge variety of more than 150 specialist degrees at Manchester Metropolitan University. Study at the university's triple-accredited Business School or at the innovative School of Digital Arts.

What will I study?

- English for Academic Purposes and Study Skills (EAP)**
- INTO Essentials**

3 out of 5*:

- Business Studies
- Economics
- Further Mathematics
- Mathematics
- Global Studies

Science and Engineering – FSE

Choose from 60+ degrees.



Prepare to study at the brand new Dalton Building for Science and Engineering, which features a 200-capacity super lab. Visit the Faculty of Science and Engineering to meet your future lecturers and discover your perfect degree.

What will I study?

- English for Academic Purposes and Study Skills (EAP)**
- INTO Essentials**

3 out of 5*:

- Biology
- Chemistry
- Further Mathematics
- Mathematics
- Physics

Scan the QR codes or visit www.intostudy.com/mmu/courses to find out more about each programme, including a full list of progression options.

* Your intended degree programme will determine the modules you are enrolled on. Some combinations may not be available. Module availability is subject to change.
** Compulsory but not credit bearing.

Dates and prices

The cost of your programme may vary depending on factors including the pathway chosen and programme length. The following guide to costs is based on pricing for the current academic year and provides an indication of the cost of attendance for some of our pathways. For specific cost information, please refer online: www.intostudy.com/mmu/courses

Estimated cost of attendance based on prices for current academic year 2022-23						
Study length	Tuition	Accommodation	Books and fees	Airport pick up**	Insurance	Total
Academic programmes						
International Foundation (3 term)	£16,475	£7,700-£13,515	£435-£835	£45	£357	£25,012-£31,227
International Foundation (4 term)	£18,495	£7,700-£13,515	£530-£930	£45	£466	£27,236-£33,451
International Year One (3 term)	£16,995	£7,700-£13,515	£435	£45	£357	£25,532-£31,347
English language courses						
1 term*	£4,650	£7,700-£13,515	£95	£45	£122	£12,522-18,287
16 weeks	£7,090	£7,700-£13,515	£135	£45	£145	£15,115-£20,930

Start months and term dates			
Academic programmes		Academic English	
September (3 term)	Mon 11 Sep 2023 - Fri 05 July 2024	August (16 weeks)	Mon 7th Aug 2023 - Fri 8th Dec 2023
September (4 term)	Mon 25 Sep 2023 - Fri 30 Aug 2024	September (1 term)	Monday 25th Sep 2023 - Fri 8th Dec 2023
January (3 term)	Mon 08 Jan 2024 - Fri 30 Aug 2024	January (1 term)	Mon 8th Jan 2024 - Fri 22 Mar 2024
		April (1 term)	Tue 02 Apr 2024 - Fri 14 Jun 2024
		June (1 term)	Mon 24 June 2024 - Fri 30 Aug 2024

Please note the prices shown are for the current academic year of 01 September 2022 - 31 August 2023 and are for indicative purposes only. For full details of term dates, please visit the relevant course page at: www.intostudy.com/mmu/courses

* The price will depend on your start date and length of study. Prices shown are only for one term. Vacation weeks in between terms are extra and will be charged at the weekly accommodation price.
** Please note airport pickup is optional and is not included in the total.

Apply online:
apply.intostudy.com

Apply via your local INTO Educational counsellor.
If you would like us to put you in contact with one of our counsellors please contact us.

Check to see if you're eligible for a scholarship:
www.intostudy.com/mmu/scholarships

Discover more online

For students:
www.intostudy.com/mmu
For education counsellors:
partnerportal.intoglobal.com/mmu



Through innovative partnerships with leading universities, we expand opportunities for higher education, ensuring success and transforming the lives of our students and staff.

INTO GIVING

Working across the globe, INTO Giving supports projects that increase access to education and improve the quality of teaching and learning. For more information visit www.into-giving.com

Contact us

www.intostudy.com/en/contact
Visit the Centre:
manchester.marketing@intoglobal.com
or +44 161 631 1200

Connect with us

- facebook.com/intomanchester
- myin.to/intomanchestervideos
- instagram.com/into_manchester

Centre address details:
INTO Manchester
Bridgewater House
58/60 Whitworth Street
Manchester
M1 6LT
United Kingdom

© INTO Manchester Limited, September 2022. Every effort is made to ensure that content published in this document is correct at the time of publication. However, from time to time there may be occasions where some of the information has changed since the date of publication. The most up to date information can be found on our website at www.intostudy.com/mmu - please refer to this before submitting your application. If, in our opinion, we consider that any change has been made which has a material impact on any offer that has been made to you to study with us, we will inform you of these changes in writing. The information provided in this document is subject to INTO Manchester in partnership with Manchester Metropolitan University's terms and conditions which can be accessed at www.intostudy.com/mmu/terms.

INTO Manchester Limited, 6438137, One Gloucester Place, Brighton, East Sussex, BN1 4AA, UK.

Education provider sponsor number 6FY6FQBV1

Education counsellor's stamp